

855 Industrial Highway Cinnaminson, New Jersey

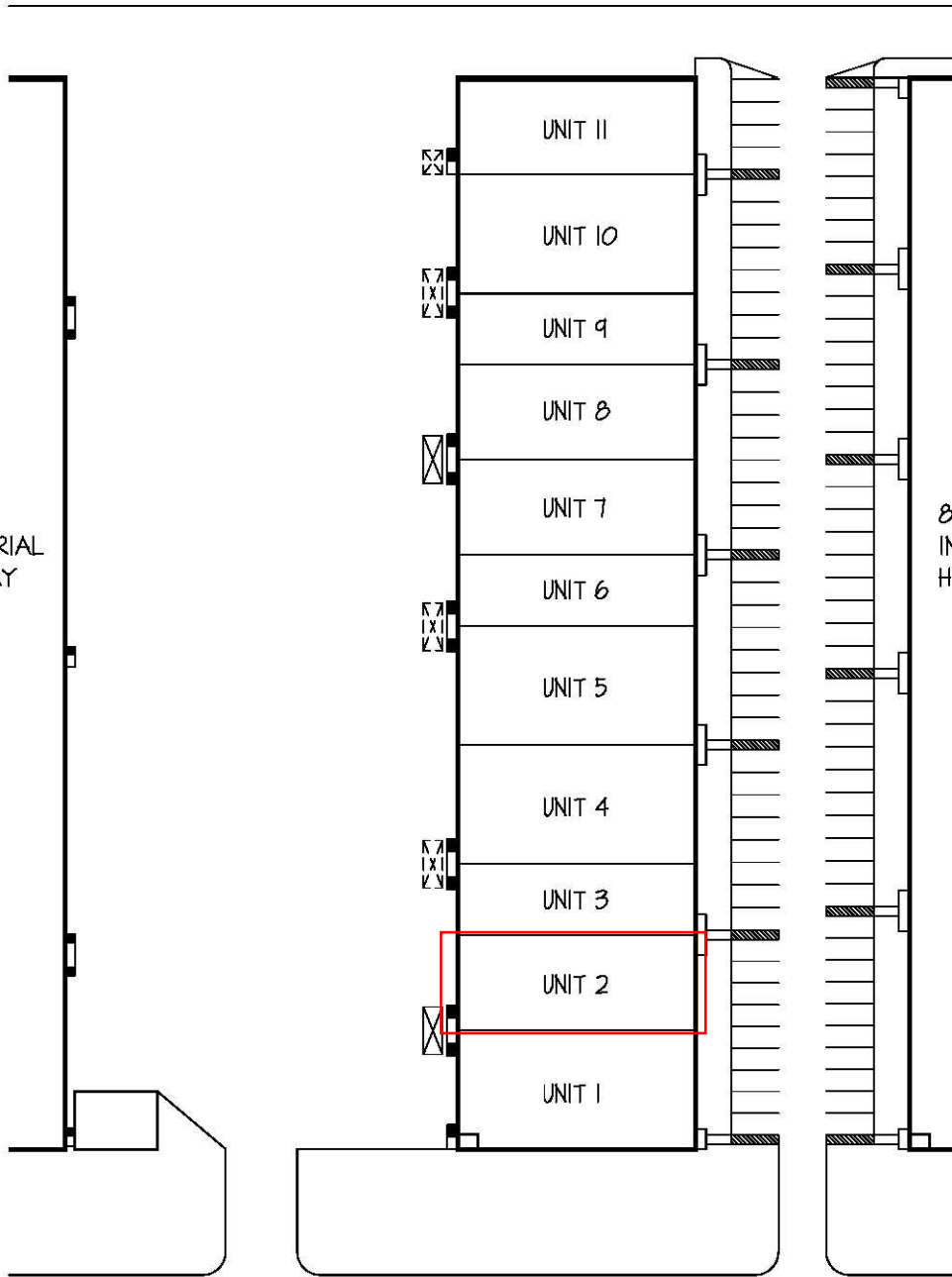

**One Underwood Court, P.O. Box 1605
Delran, New Jersey 08075-0117
(856) 764-2600
E-mail: leasing@whitesellco.com**

835
INDUSTRIAL
HIGHWAY



875
INDUSTRIAL
HIGHWAY

FEATURES:

- 45,034 SQ. FT. TOTAL
- ELECTRICAL SERVICE:
- 120/208 V -3Ø-2000A
- HVAC: - GAS HEAT
- OFFICE AIR CONDITIONED
- (11) 10'-0" x 10'-0" DOCK DOORS
- 45 PARKING SPACES
- PUBLIC WATER, SEWER & GAS
- CLEARANCE HEIGHT:
UNITS #1 - 5:
MIN. = 14'-2"
MAX. = 14'-6"
UNITS #5 - 11:
MIN. = 14'-6"
MAX. = 14'-10"



Whitesell Construction Co. Inc.

One Underwood Court
Delran, New Jersey 08075
(856) 764-2600

UNIT No.

SITE

DATE:

03/14/08

SCALE:

1" = 80'

**855 INDUSTRIAL HIGHWAY
CINNAMINSON, NEW JERSEY**

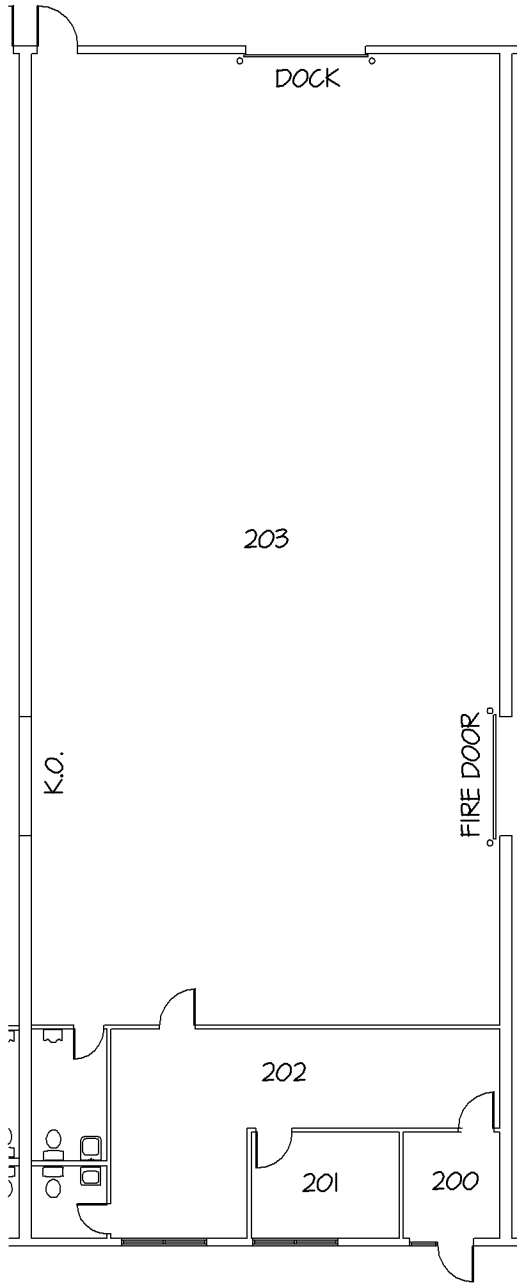

FEATURES:

- 4,005 SQ. FT. TOTAL
 - OFFICE: 780 SQ. FT.
 - WAREHOUSE: 3,225 SQ. FT.
- ELECTRICAL SERVICE:
 - 208/120 VOLTS; 3 PHASE; 200 AMPS
- MECHANICAL SERVICE:
 - GAS HEAT
 - OFFICE AIR CONDITIONED
- CLEAR HEIGHT: MIN. = 14'-2"
MAX. = 14'-6"
- (1) 10'-0" x 10'-0" DOCK DOOR

APPROX. ROOM SIZES:

- 200 - 8'-10" x 8'-0"
- 201 - 8'-10" x 12'-4"
- 202 - OPEN OFFICE AREA
- 203 - 80'-11" x 39'-0"



Whitesell

One Underwood Court, Delran, New Jersey 08075
Phone: (856) 764-2600 Web: www.whitesellco.com

UNIT No.

UNIT 2

DATE:

03/25/13

SCALE:

1/16" = 1'-0"

855 INDUSTRIAL HIGHWAY
CINNAMINSON, NEW JERSEY