

500 Richards Run Burlington, NJ

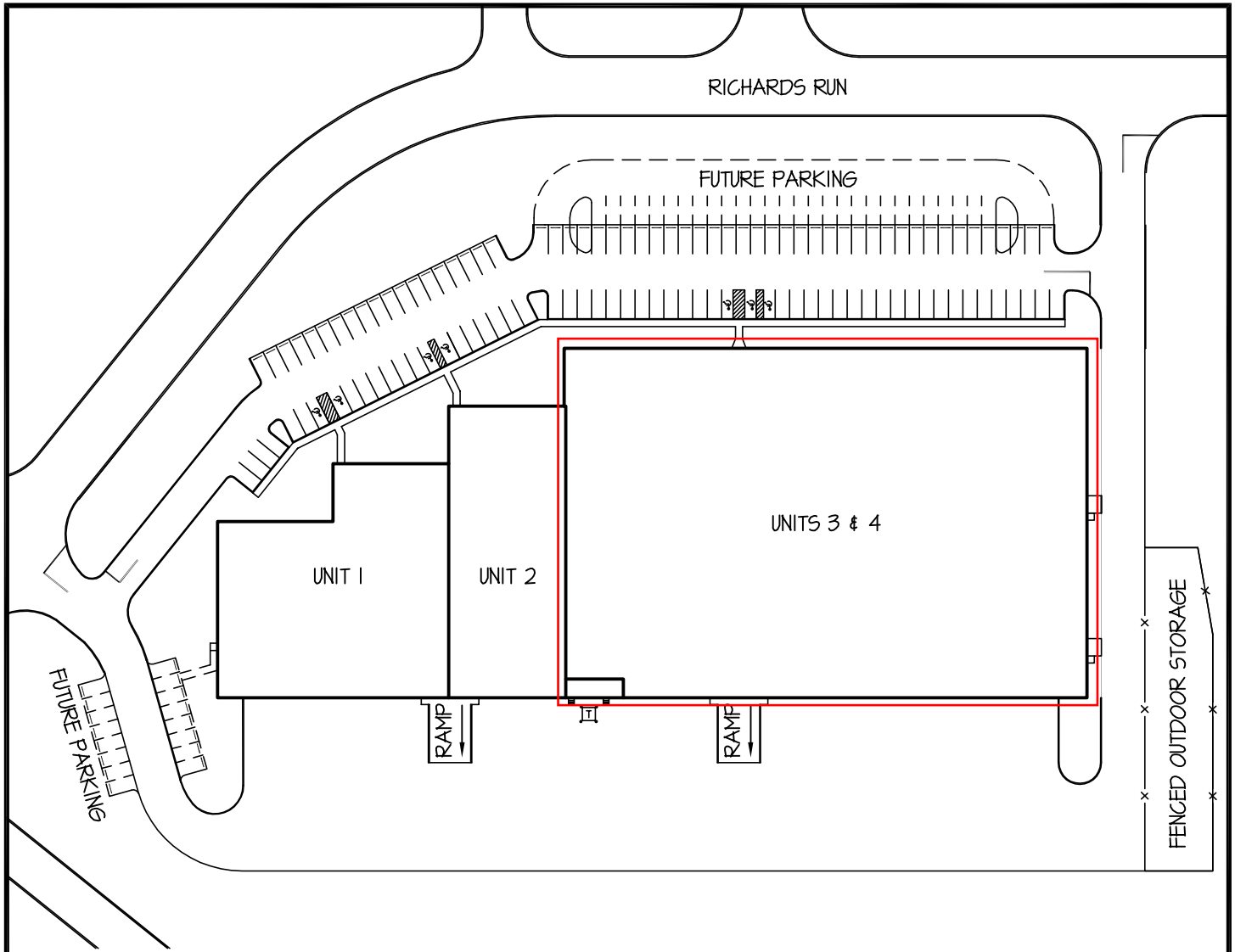

**One Underwood Court, P.O. Box 1605
Delran, New Jersey 08075-0117
(856) 764-2600
E-mail: leasing@whitesellco.com**



FEATURES:

- 126,484 SQ. FT. TOTAL
- ELECTRICAL SERVICE:
 - 480/277 VOLTS; 3 PHASE; 3000 AMPS
 - W/ 208/120 VOLT SUBPANELS
- FIBER OPTICS AVAILABLE AT UTILITY ROOM
- MECHANICAL SERVICE:
 - GAS HEAT
 - OFFICE AIR CONDITIONED
- TYPICAL STRUCTURAL BAY:
 - 40'-0" x 40'-0"
- CLEAR HEIGHT: 23'-2" MIN.
24'-0" AT FIRST COLUMN LINE
- (22) 8'-0" x 10'-0" DOCK DOORS
- (5) 12'-0" x 14'-0" DRIVE-IN DOORS
- (1) 26'-0" x 14'-0" DRIVE-IN DOOR
- PUBLIC WATER & SEWER
- 112 PARKING SPACES
 - 148 POSSIBLE FUTURE SPACES
- ZONING: I-2 (INDUSTRIAL HEAVY)



Whitesell

One Underwood Court, Delran, New Jersey 08075
Phone: (856) 764-2600 Web: www.whitesellco.com

UNIT No.

SITE

DATE:

03/16/17

SCALE:

SCALE

**500 RICHARDS RUN
BURLINGTON, NEW JERSEY**

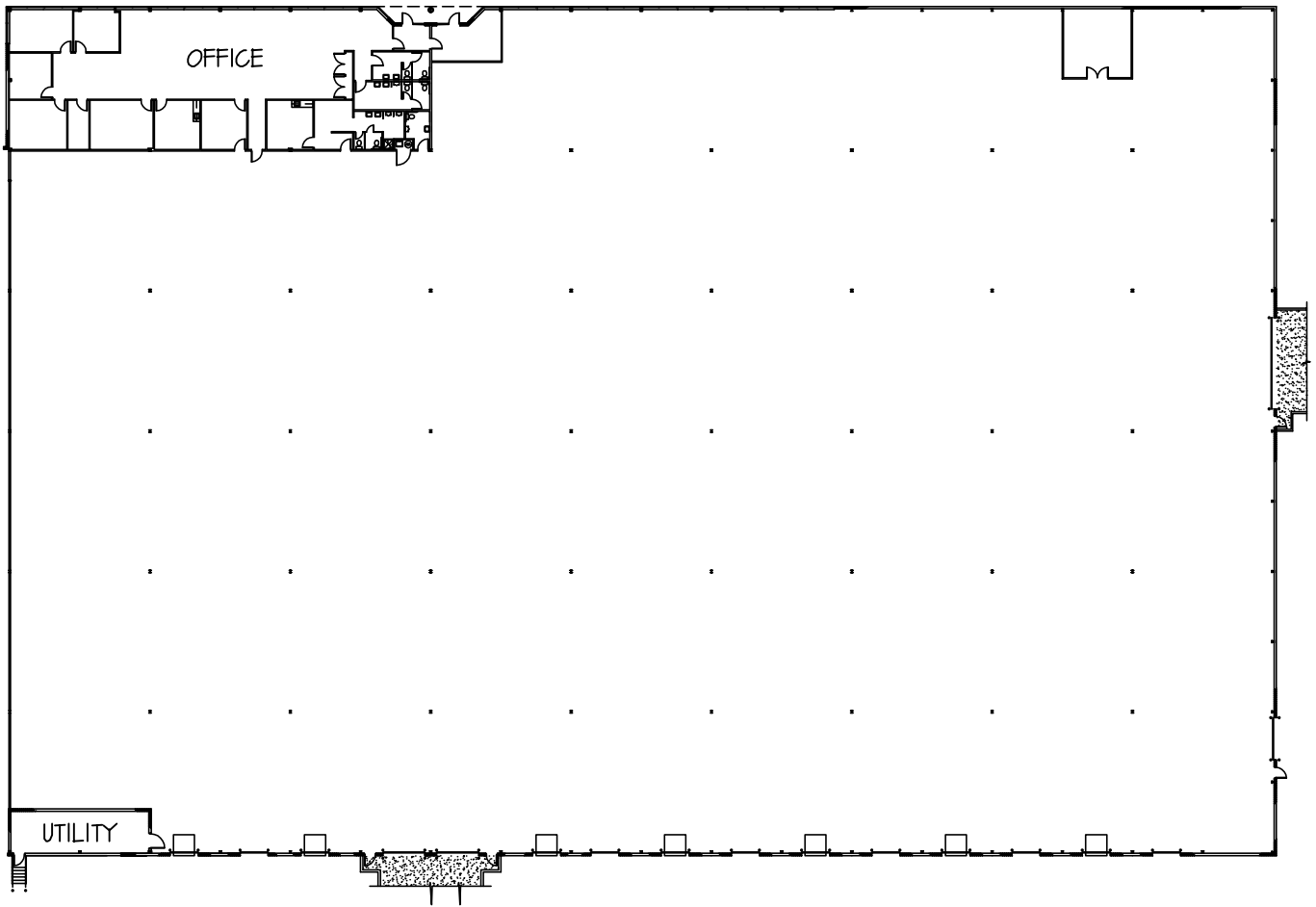

FEATURES:

- 87,241 SQ. FT. TOTAL
 - OFFICE: 5,000 SQ. FT.
 - WAREHOUSE: 82,241 SQ. FT.
- ELECTRICAL SERVICE:
 - 480/277 VOLTS; 3 PHASE; 2,200 AMPS
 - W/ 208/120 VOLT SUBPANELS
- MECHANICAL SERVICE:
 - GAS HEAT
 - OFFICE AIR CONDITIONED
- TYPICAL STRUCTURAL BAY:
 - 40'-0" x 40'-0"
- CLEAR HEIGHT: 23'-2" MIN.
24'-0" AT FIRST COLUMN LINE
28'-2" MAX.
- (13) 8'-0" x 10'-0" DOCK DOORS
- (3) 12'-0" x 14'-0" DRIVE-IN DOORS
- (1) 26'-0" x 14'-0" DRIVE-IN DOOR



Whitesell

One Underwood Court, Delran, New Jersey 08075
Phone: (856) 764-2600 Web: www.whitesellco.com

UNIT No.

UNITS 3 & 4

DATE:

03/16/17

SCALE:

N.T.S.

500 RICHARDS RUN
BURLINGTON, NEW JERSEY