

# 1200A Taylors Lane Cinnaminson, New Jersey

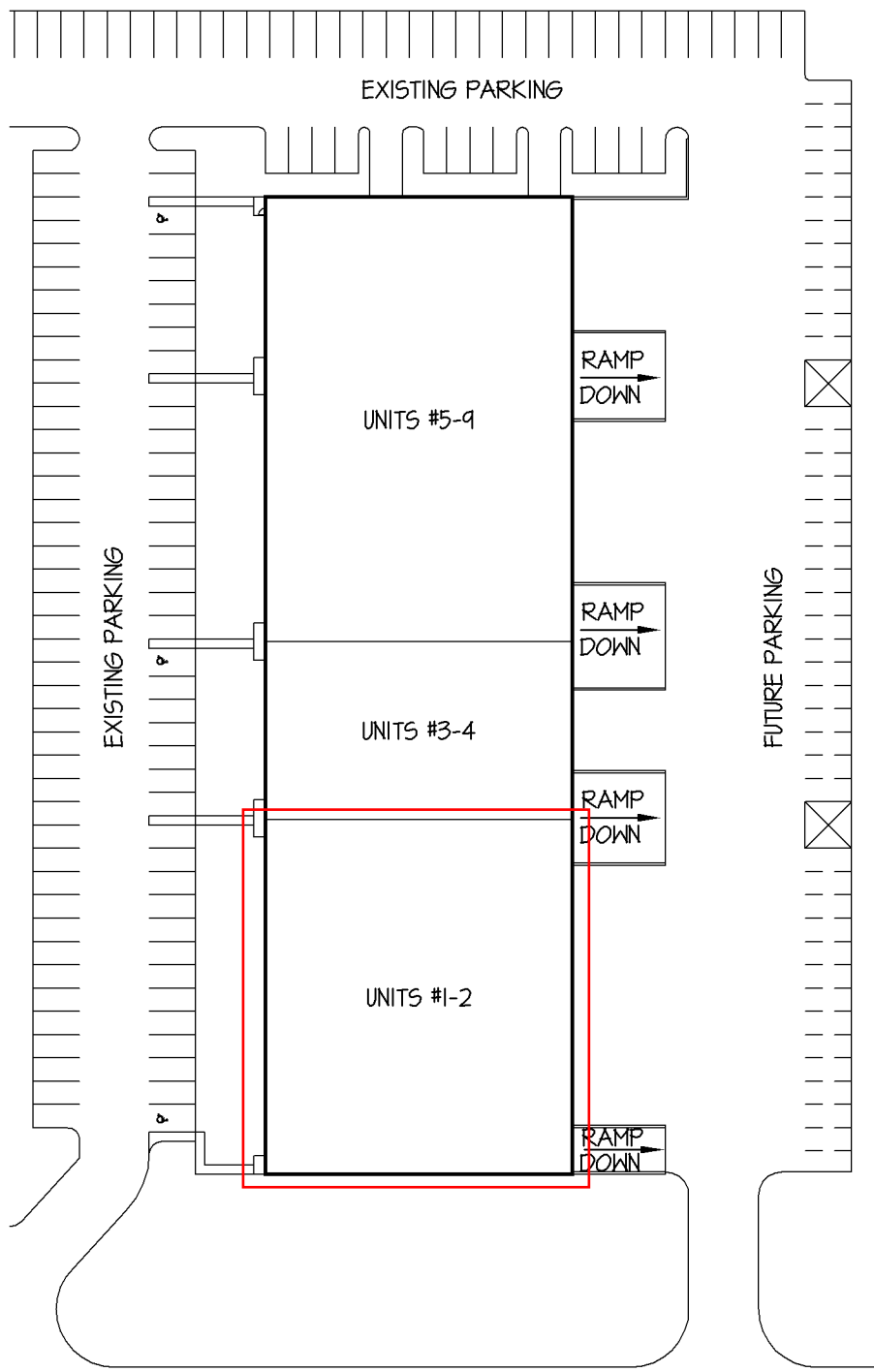

One Underwood Court, P.O. Box 1605  
Delran, New Jersey 08075-0117  
(856) 764-2600  
E-mail: [leasing@whitesellco.com](mailto:leasing@whitesellco.com)



**FEATURES:**

- 55,440 SQ. FT. TOTAL
- ELECTRICAL SERVICE:
  - 480/277 VOLTS, 3 PHASE, 800 AMPS
- PUBLIC WATER, SEWER, & GAS
- CLEARANCE HEIGHT:
  - MIN. = 20'-0"
  - MAX. = 23'-4"
- TYPICAL STRUCTURAL BAY:
  - 38'-0" x 50'-0"
- (15) 8'-0" x 10'-0" DOCK DOORS
- (9) 10'-0" x 12'-0" DRIVE-IN DOORS
- 128 EXISTING PARKING SPACES  
43 FUTURE PARKING SPACES

TAYLORS LANE



**Whitesell**

One Underwood Court, Delran, New Jersey 08075  
Phone: (856) 764-2600 Web: www.whitesellco.com

UNIT No.

SITE

DATE:

12/04/12

SCALE:

1" = 80'-0"

**1200A TAYLORS LANE  
CINNAMINSON, NEW JERSEY**

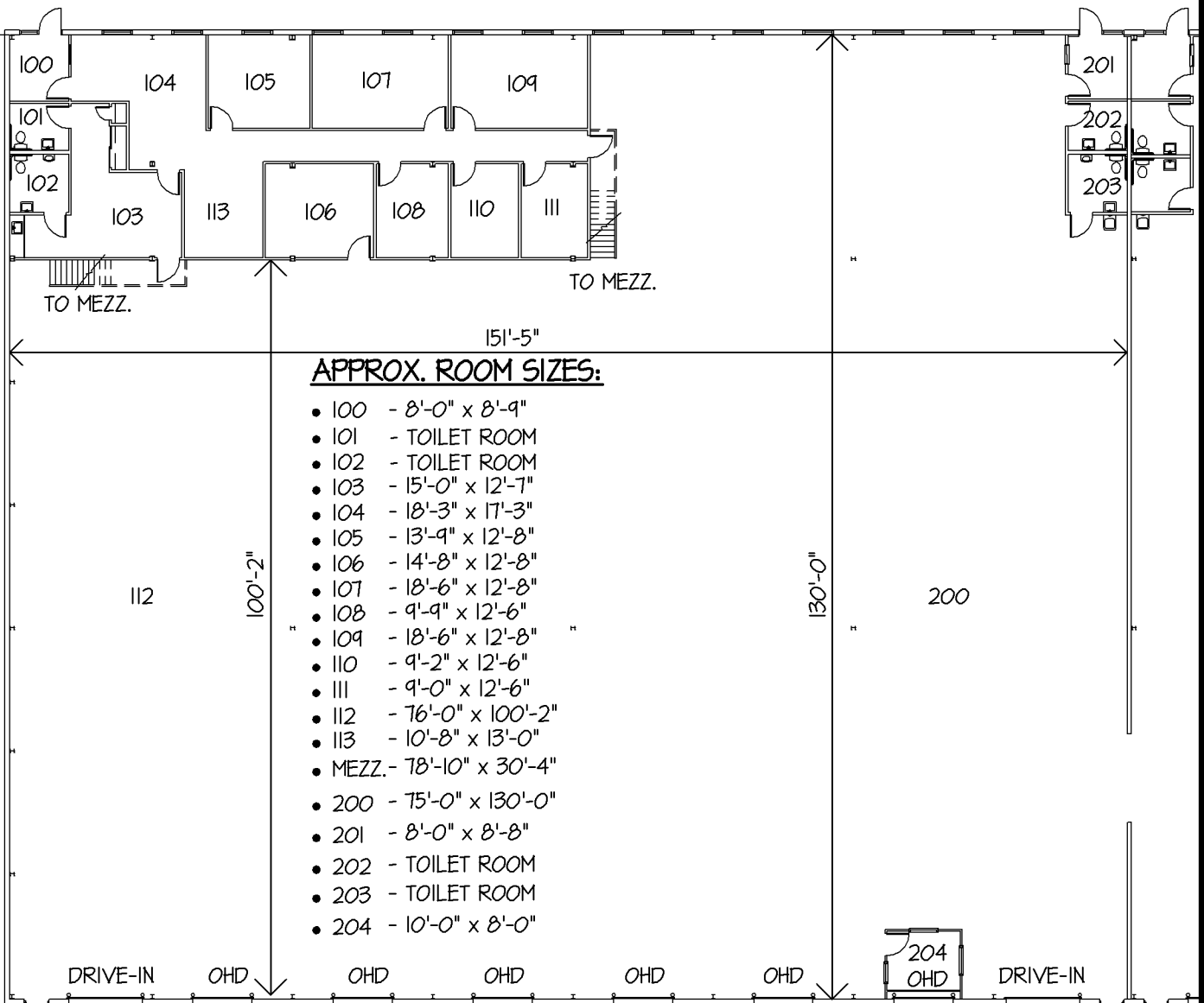

**FEATURES:**

- 20,148 SQ. FT. TOTAL  
     OFFICE: 2,474 SQ. FT.  
     WAREHOUSE: 17,674 SQ. FT.
- ELECTRICAL SERVICE:  
     480/277 VOLTS, 3 PHASE,  
     400 AMPS, TRANSFORMED TO  
     208/120 VOLTS
- MECHANICAL SERVICE:  
     - GAS HEAT  
     - OFFICE AIR CONDITIONED
- TYPICAL STRUCTURAL BAY:  
     38'-0" x 50'-0"
- FRONT STRUCTURAL BAY:  
     38'-0" x 30'-0"
- CLEARANCE HEIGHT:  
     - MIN. = 20'-0"  
     - MAX. = 23'-4"
- (6) 8'-0" x 10'-0" DOCK DOORS  
     (5 DOORS OPERATIONAL)
- (2) 10'-0" x 12'-0" DRIVE-IN DOOR
- MEZZ. LOAD CAPACITY: 100 P.S.F.



**Whitesell Construction Co. Inc.**

One Underwood Court  
 Delran, New Jersey 08075  
 (856) 764-2600

UNIT No. <b>UNIT 1 &amp; 2</b>	DATE: <b>12/20/11</b>	SCALE: <b>NTS</b>
-----------------------------------	--------------------------	----------------------

**1200A TAYLORS LANE  
 CINNAMINSON, NEW JERSEY**