

1000 Taylors Lane Cinnaminson, New Jersey

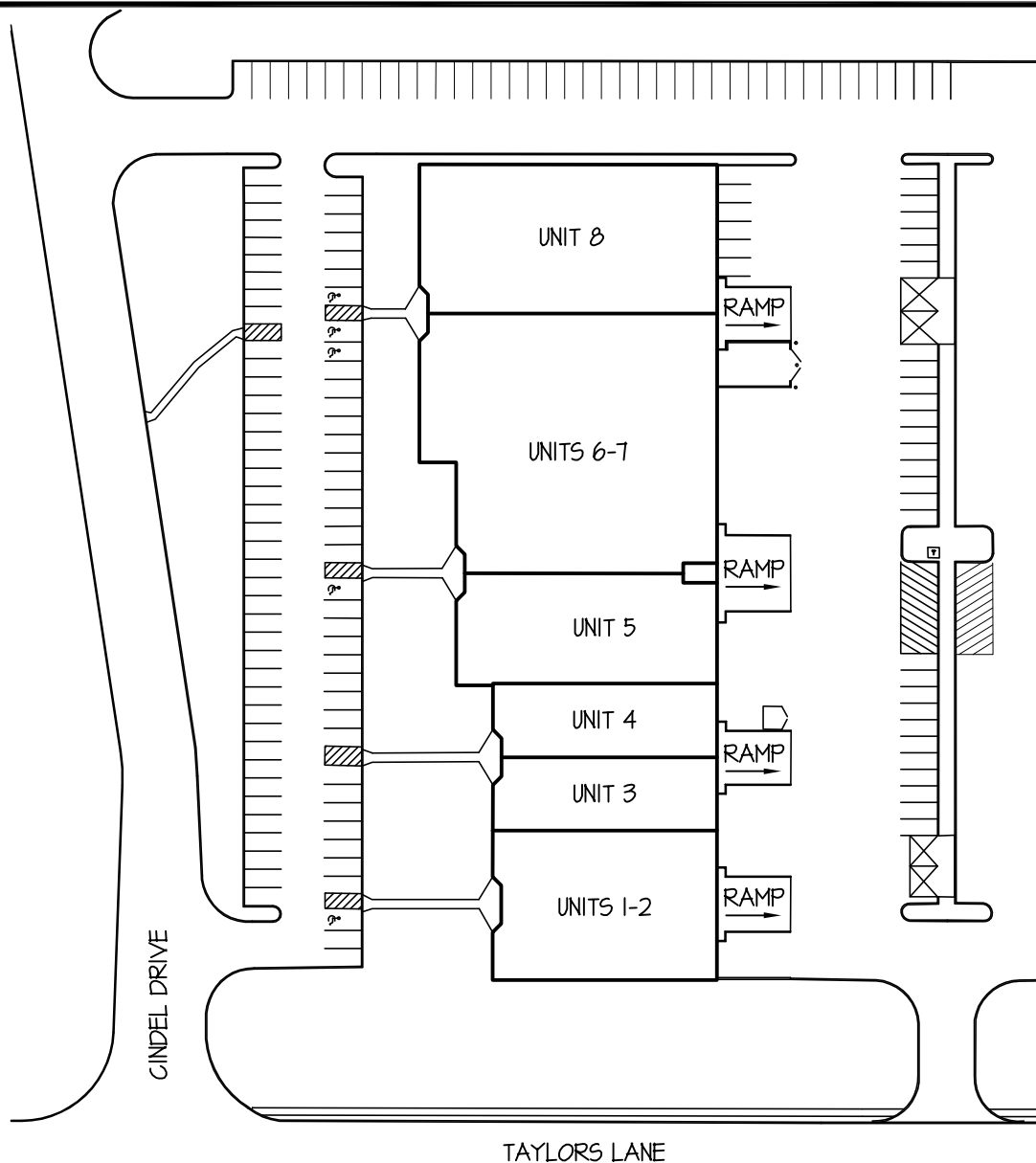

One Underwood Court, P.O. Box 1605
Delran, New Jersey 08075-0117
(856) 764-2600
E-mail: leasing@whitesellco.com



FEATURES:

- 62,993 SQ. FT. TOTAL
- ELECTRICAL SERVICE:
 - 480/277 VOLTS; 3 PHASE; 800 AMPS
 - 208/120 VOLTS
- MECHANICAL SERVICE:
 - GAS HEAT
 - OFFICE AIR CONDITIONED
- TYPICAL STRUCTURAL BAY:
 - 40'-0" x 40'-0"
- (14) 8'-0" x 10'-0" DOCK DOORS
- (8) 12'-0" x 14'-0" DRIVE-IN DOORS
- CLEAR HEIGHT:
 - UNITS 1-4:
 - MIN. = 22'-2"
 - MAX. = 24'-2"
 - UNITS 5-6:
 - MIN. = 22'-2"
 - MAX. = 24'-6"
 - UNITS 7-8:
 - MIN. = 22'-2"
 - MAX. = 24'-10"
- PUBLIC WATER & SEWER
- 153 PARKING SPACES
- ZONING: IND (INDUSTRIAL)



Whitesell

One Underwood Court, Delran, New Jersey 08075
 Phone: (856) 764-2600 Web: www.whitesellco.com

UNIT No.	DATE:	SCALE:
SITE	02/28/13	1" = 100'

**1000 TAYLORS LANE
 CINNAMINSON, NEW JERSEY**

FEATURES:

- 16,487 SQ. FT. TOTAL
- ELECTRICAL SERVICE:
 - 480/277V-3Φ-200A
 - 120/208V
- MECHANICAL SERVICE:
 - GAS HEAT
 - OFFICE AIR CONDITIONED
- CLEARANCE HEIGHT:
 - MIN. = 22'-2"
 - MAX. = 24'-6"
- (1) 10'-0" x 12'-0" DRIVE-IN DOOR

APPROX. ROOM SIZES:

- 800 - 9'-10" x 8'-5"
- 801 - 13'-8" x 12'-4"
- 802 - 6'-4" x 8'-7"
- 803 - 13'-8" x 38'-1"
- 804 - 13'-8" x 14'-0"
- 805 - 13'-8" x 11'-9"
- 806 - 13'-8" x 7'-10"
- 807 - 6'-6" x 8'-6"
- 808 - 13'-8" x 40'-1"
- 809 - 19'-0" x 10'-2"
- 810 - 60'-9" x 35'-7"
- 811 - 11'-7" x 9'-6"
- 812 - 60'-9" x 35'-7"
- 813 - 11'-7" x 17'-9"
- 814 - 22'-0" x 17'-9"
- 815 - 26'-6" x 25'-10"
- 816 - 10'-0" x 11'-0"
- 817 - OPEN OFFICE AREA
- 818 - 12'-3" x 9'-10"
- 819 - 15'-4" x 9'-10"
- 820 - 19'-10" x 13'-1"
- 821 - 19'-1" x 13'-1"
- 822 - 15'-0" x 8'-0"
- 823 - 8'-1" x 8'-1"
- 824 - 8'-1" x 8'-1"
- 825 - 8'-1" x 4'-0"
- 826 - 10'-0" x 13'-0"
- 827 - OPEN OFFICE AREA

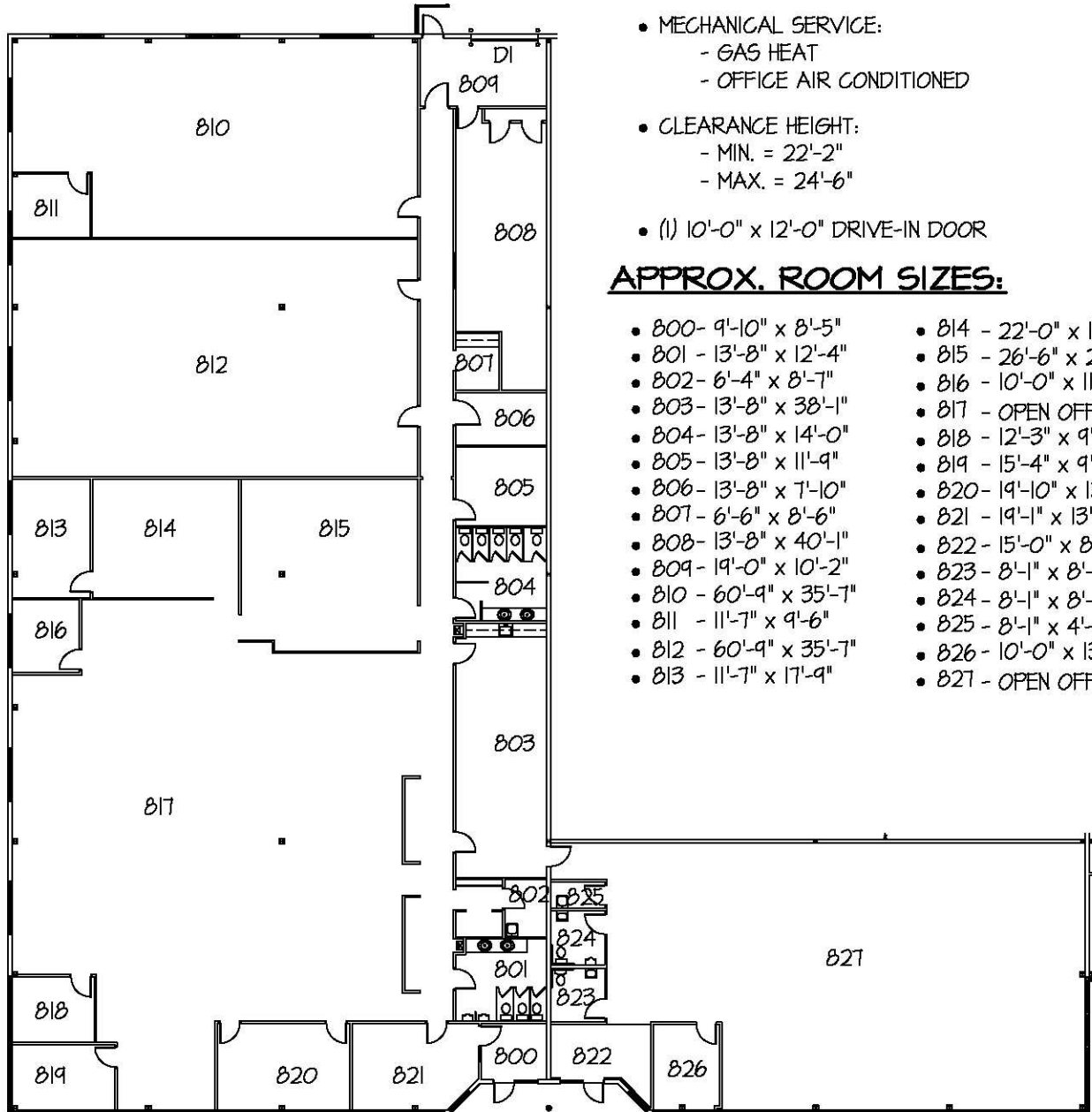

Whitesell Construction Co. Inc.

One Underwood Court
 Delran, New Jersey 08075
 (856) 764-2600

UNIT No.

UNIT 8

DATE:

06/11/08

SCALE:

1" = 20'-0"

1000 TAYLORS LANE
 CINNAMINSON, NEW JERSEY